

Tenth Floor

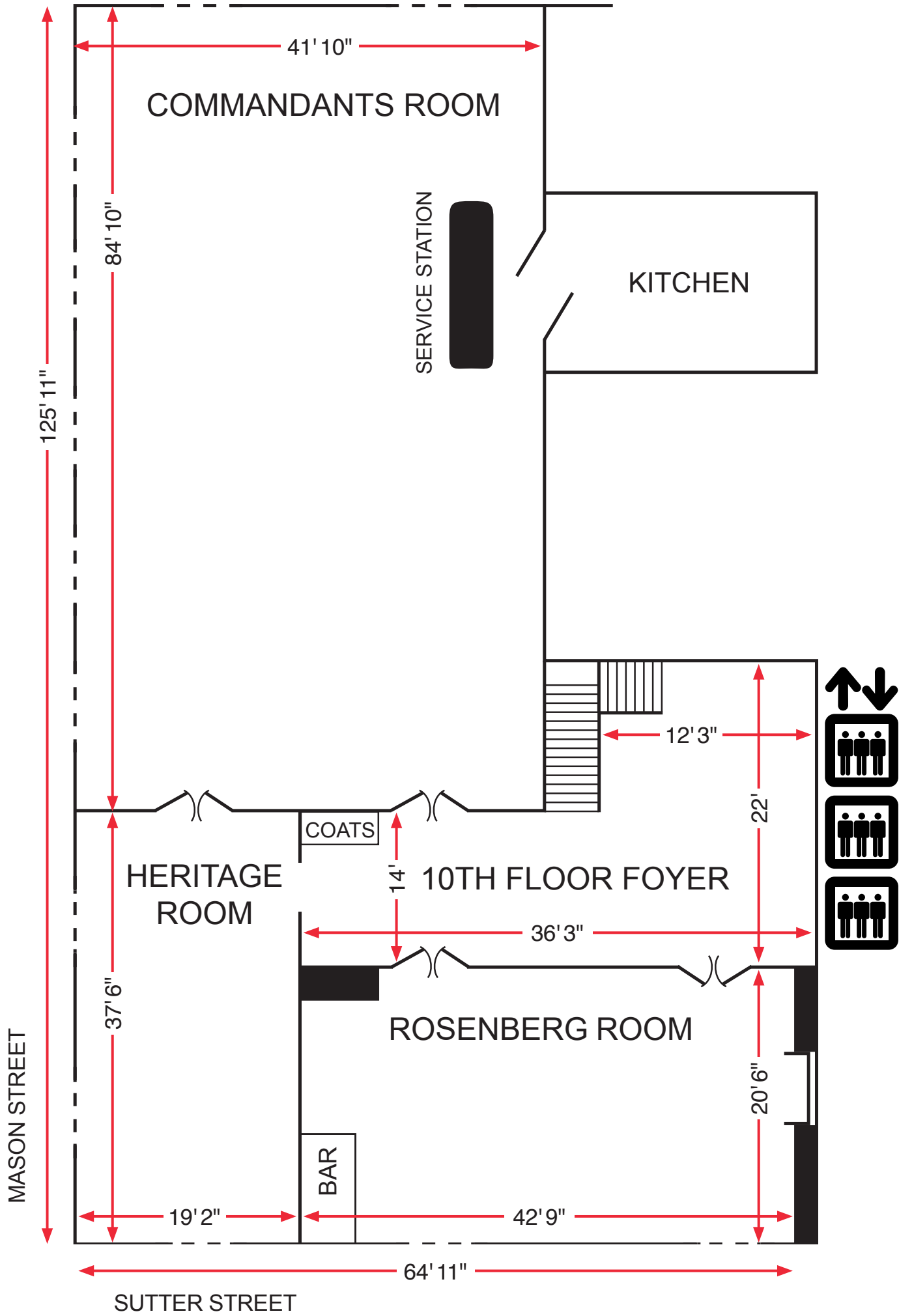

| | ROSENBERG | HERITAGE | COMMANDANTS |
|-----------------|-----------------|-----------------|-------------------|
| Room Dimensions | 20' 6" x 42' 9" | 19' 2" x 37' 6" | 41' 10" x 84' 10" |
| Square Footage | 884 | 722 | 3,456 |
| Ceiling Height | 22' | 19' | 20' |
| Banquet | 60 | 50 | 330 |
| Reception | 85 | 75 | 350 |
| Classroom | 48 | 44 | 210 |
| Theater | 60 | 55 | 300 |

Eleventh Floor

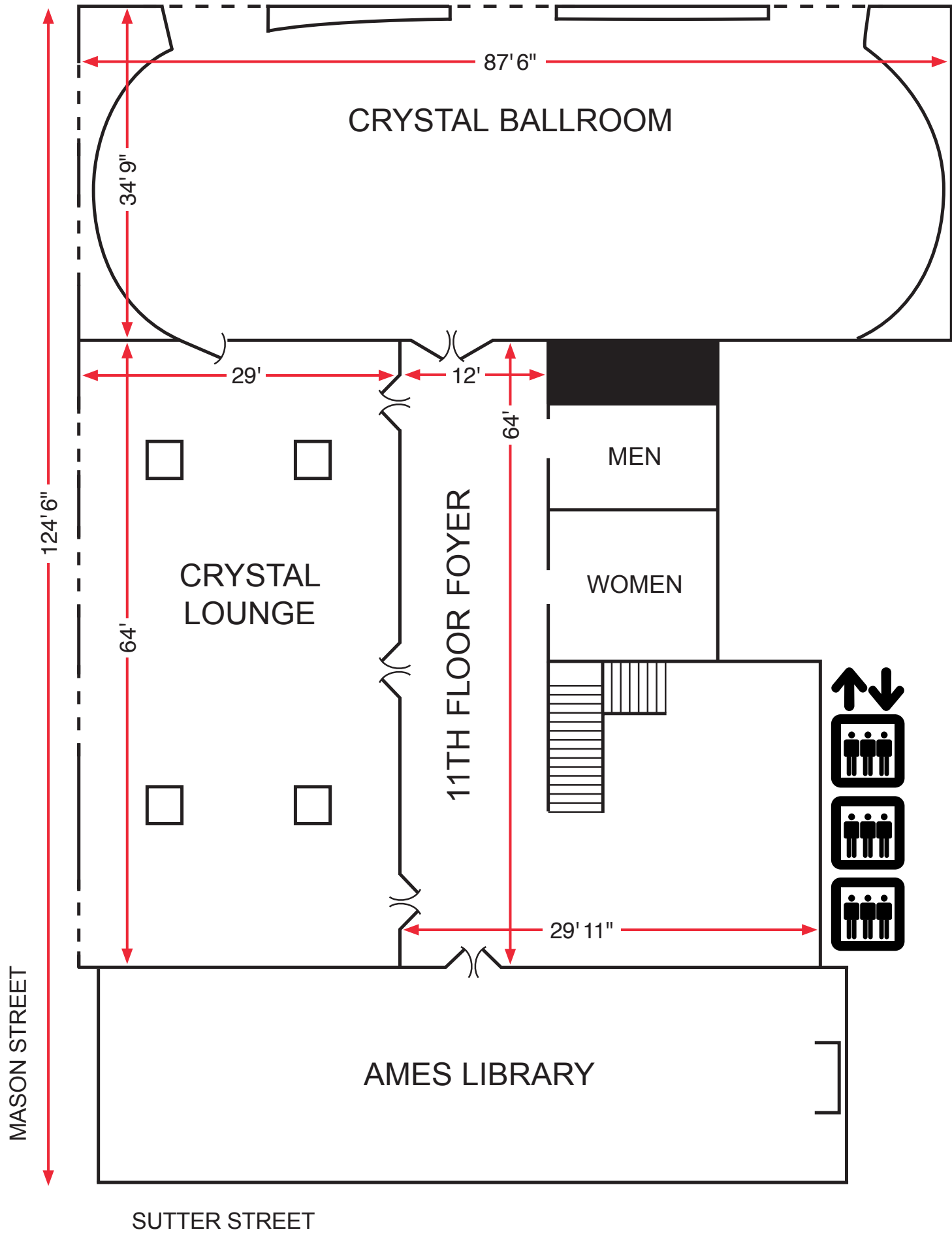

| | BALLROOM | LOUNGE |
|------------------------|-----------------|---------------|
| Room Dimensions | 34' 9" x 87' 6" | 29' x 64' |
| Square Footage | 3,057 | 1,856 |
| Ceiling Height | 17' | 18' |
| Banquet | 250 | 120 |
| Reception | 300 | 170 |
| Classroom (18" tables) | 152 | 64 |
| Theater | 216 | 100 |

Marines' Memorial Theatre

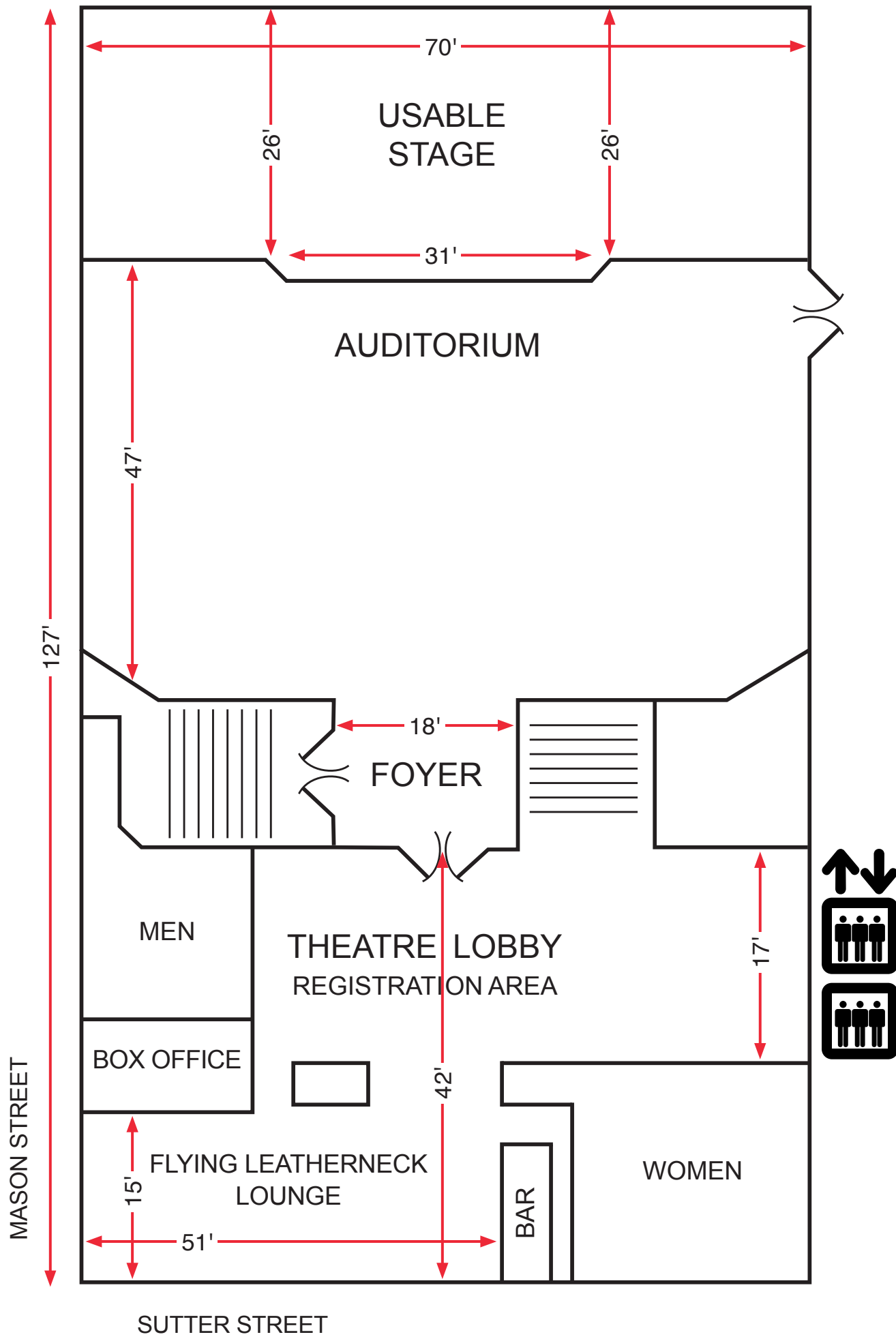

THEATRE DIMENSIONS

| | | |
|--------------|-----------|---------------|
| Usable Stage | 31' x 26' | 806 sq. ft. |
| House | 47' x 54' | 3,055 sq. ft. |

THEATRE SEATING

| | |
|-----------|-----|
| Balcony | 220 |
| Orchestra | 344 |
| Total | 564 |

THEATRE LOBBY DIMENSIONS

| | |
|---------------------------|---------------|
| Registration Area | 884 sq. ft. |
| Flying Leatherneck Lounge | 765 sq. ft. |
| Registration and Lounge | 1,649 sq. ft. |
| Reception Capacity | 150 people |